

INSTALLATION INSTRUCTIONS

Towel warmer

Only Electric version

NOTE! NEVER DRILL HOLES IN THE WALL WITHOUT FIRST CHECKING THE DIMENSIONS OF THE SPECIMEN.

There may be slight size differences. Nordhem disclaims all liability if pre-drilling is done without having measured the specimen.

The dimensions listed are only intended for preparing possible noggins and electricity.

If the towel warmer should be hard wired, this must be done by a qualified electrician.

Class II Double isolated

Volt 230 ~ 50Hz

Protection class: IP44

(NOTE! Approved for 2- pole installation without ground connection)

DRAWING

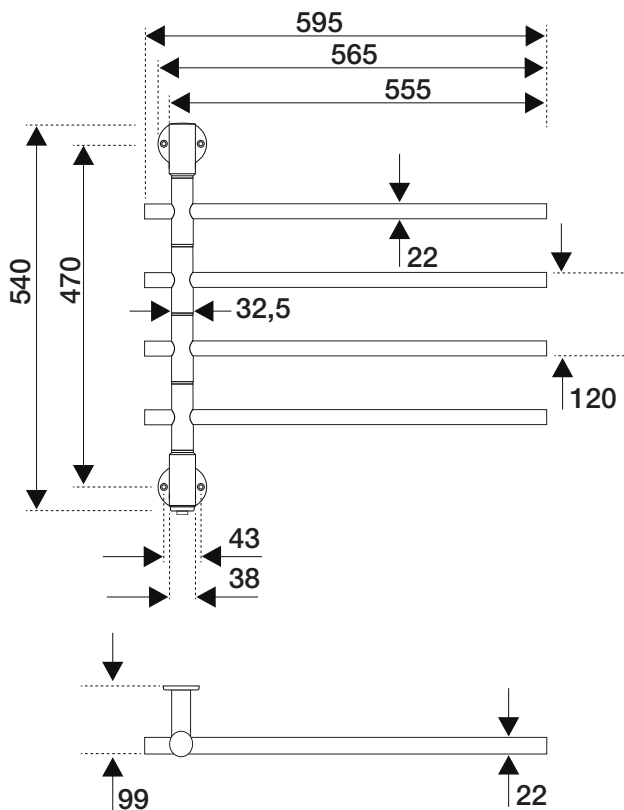

For drawings of other models, see website

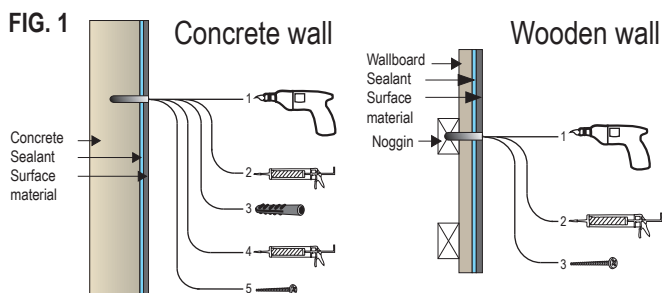
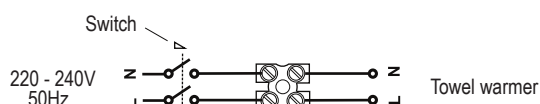

FIG. 2



ASSEMBLY, HIDDEN CONNECTION WITH CABLE DIRECTLY FROM THE WALL.

The towel warmer should be attached to a solid construction, e.g., generally concrete or special construction detail. Screw fixings may not be mounted only in the wallboard. The water proofing must be restored carefully. (See Fig. 1). The hole must not be drilled so deep that the silicone can be pushed through the noggin. A wooden wall with dukka board or similar product shall be sealed by adding silicone in the hole before the screws are mounted. A concrete wall shall be sealed with silicone both before inserting the plug and then before the screw is screwed in

- ① Hold the towel warmer against the wall in the desired position (make sure it is at a suitable height from the floor, consider the risk of burns with small children!). Mark the position of the brackets on the wall. Make sure that the bracket is level when the markings are made.
- ② Drill the holes in the wall, put the silicone into the holes and then insert the plugs (if needed depending on surface).
- ③ Connect the power cord from the wall in the 2-pin terminal block (see Fig. 2). Then insert the terminal block in the protective connection capsule and push the capsule and cables in to the bracket/foot. NOTE! Hard wiring must be done by a qualified electrician.
- ④ Attach the brackets to the wall. NOTE! Make sure that no wires are pinched between the wall and bracket.

ASSEMBLY, EXTERNAL PLUG.

- ① Follow the instructions for wall mounting under 1 and 2 above.
- ② Remove the gray plastic plug on the bottom bracket.
- ③ Install the power cable (eg cord set; 1.5m cord with plug, art.no SFV15) through the hole in the bottom bracket. Use the strain relief. NOTE! The nut for the strain relief must be tilted when inserted into the bracket. The diameter of the hole is 15mm.
- ④ Connect the power cord from the cord set in the 2-pin terminal block (see Fig. 2). Then insert the terminal block in the protective connection capsule and push the capsule and cables in to the bracket/foot.
- ⑤ Tighten the strain relief entry and then insert the plug in the wall socket.

SAFETY INFORMATION AND DIRECTIONS FOR USE

Towel warmer

Only Electric version

Important safety instructions

Important safety instructions

1. This product is intended for residential use, not for commercial or industrial use.
2. Do not use the product for purposes other than intended.
3. To protect against fire, electric shock or injury, no part of the cord, plug or product may be in water or other liquid. It is good if the product is preceded by a RCD.
4. Before the product is switched on, the voltage and frequency of the supply current must be according to the data label on the product.
5. The warranty is not valid if the usage violates the safety regulations for the product.
6. Do not use outdoors. Do not place near heat sources such as gas heaters or electric radiators.
7. Beware of the risk of burns! The towel warmer becomes hot during operation! Children should be supervised to ensure that they do not play with the product.
8. This product is not intended to be used by children or persons with reduced physical, sensory or mental capabilities, or lack of experience and knowledge, unless they are supervised or instructed concerning the use by a person responsible for their safety.
9. Warning! In order to avoid a hazard for small children the towel warmer should be mounted so that the lowest heated pipe is at least 600mm from the floor.
10. The product should not be lifted only in the cord. To disconnect, unplug the power plug from the outlet. Do not jerk the cord, instead pull the plug.
11. Do not let the cord hang over the product or on a table edge.
12. If the cord is damaged in any way it must be replaced. This must be done by an appointed serviceman otherwise the warranty will no longer be valid.
13. Do not attempt to repair this product yourself. It should be done by an expert or appointed serviceman otherwise the warranty will no longer be valid.
14. Never install or use the product if the cord is damaged. Bring the product to the dealer.
15. Voltage and frequency of the supply current must be according to the data label on the product.

Specific safety instructions

1. The surface reaches high temperatures. Do not touch the surface during operation.
2. The product should only be repaired by Nordhem Värme (or appointed serviceman). Mistakes in a repair can lead to great danger for the user.

Use

The first few times you use the towel warmer, it can emit a slight burnt smell. This is not a fault, but quite normal when the insulation heats up the first few times. The towel warmer is turned on by pressing the button located at the bottom of the vertical pipe. To turn off the warmer, press the button again.

Use in wet areas

You may use the product in a wet area if the following criteria are met:

- Minimum distance from the socket to the bath, basin or other sanitary installation must be at least 0.6m, preferably 1.0m.
- The product may be installed in area 2 but the socket must be in unclassified area.
- The product may be connected directly in a connection box if desired.

Cleaning

- Make sure the dryer is turned off and cool before cleaning.
- Cleaning is best done with a soft cloth and mild detergent.
- Do not use abrasive cleaners.